

HL

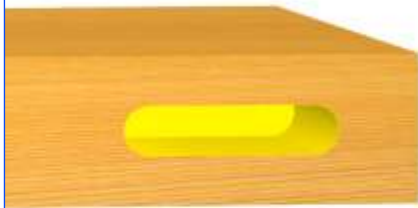

D	LT	S	Z	COD. RH	COD. LH
6	105	13x50	2	05080613R0	05080613L0
6	105	16x50	2	05080616R0	05080616L0
7	110	13x50	2	05080713R0	05080713L0
7	110	16x50	2	05080716R0	05080716L0
8	115	13x50	2	05080813R0	05080813L0
8	115	16x50	2	05080816R0	05080816L0
9	120	13x50	2	05080913R0	05080913L0
9	120	16x50	2	05080916R0	05080916L0
10	125	13x50	2	05081013R0	05081013L0
10	125	16x50	2	05081016R0	05081016L0
11	130	13x50	2	05081113R0	05081113L0
11	130	16x50	2	05081116R0	05081116L0
12	135	13x50	2	05081213R0	05081213L0
12	135	16x50	2	05081216R0	05081216L0
13	140	13x50	2	05081313R0	05081313L0
13	140	16x50	2	05081316R0	05081316L0
14	145	13x50	2	05081413R0	05081413L0
14	145	16x50	2	05081416R0	05081416L0
15	150	13x50	2	05081513R0	05081513L0
15	150	16x50	2	05081516R0	05081516L0
16	155	13x50	2	05081613R0	05081613L0
16	155	16x50	2	05081616R0	05081616L0
17	160	13x50	2	05081713R0	05081713L0
17	160	16x50	2	05081716R0	05081716L0
18	165	13x50	2	05081813R0	05081813L0
18	165	16x50	2	05081816R0	05081816L0
19	170	13x50	2	05081913R0	05081913L0
19	170	16x50	2	05081916R0	05081916L0
20	175	13x50	2	05082013R0	05082013L0
20	175	16x50	2	05082016R0	05082016L0



Slot mortise bit with chip-breakers.



Broca para escoplear con ranuras para salida de viruta.



Mèche à mortaiser avec brise - copeaux.



Langlochbohrer mit Spanbrecher.

# 509

## Confezione di 6 punte per mortasare a taglienti diritti con rompitruciolo ( art. 508 )

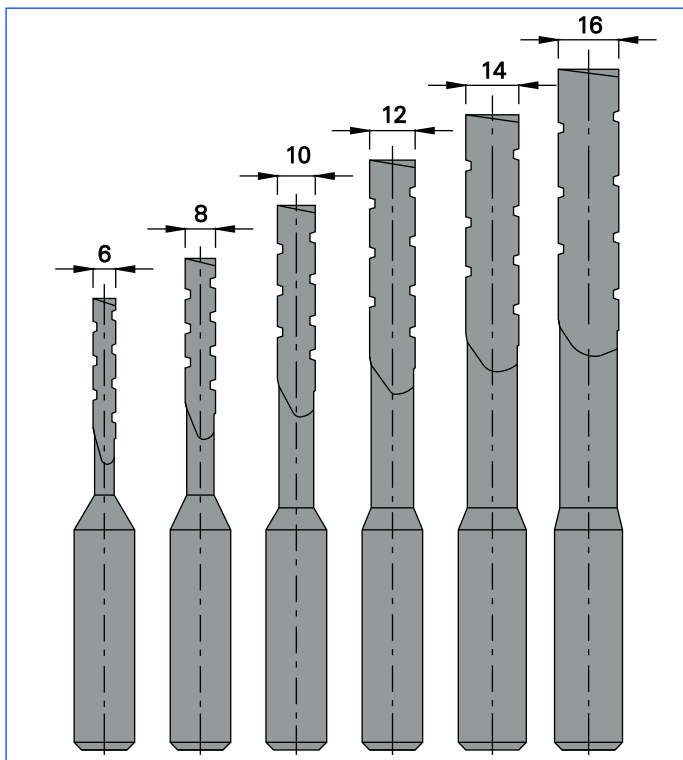

**HL**

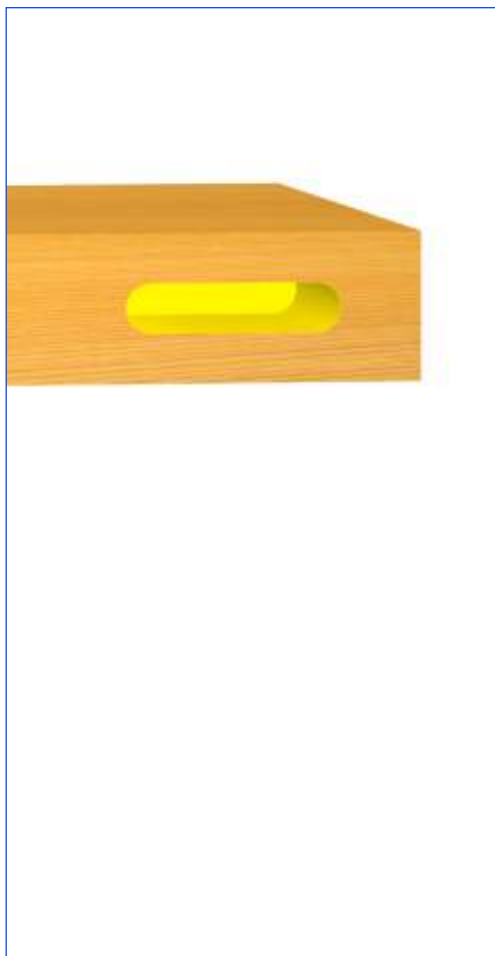

S	Z	COD. RH	COD. LH
13x50	2	05090013R0	05090013L0
16x50	2	05090016R0	05090016L0

 Set of 6 mortise bits with chip-breakers. ( Art. 508 )

 Grupo de 6 brocas para escoplear con ranuras para salida de viruta. (Art. 508 )

 Jeu de 6 mèches à mortaiser avec brise - copeaux. ( Art. 508 )

 Bohrersatz bestehend aus Nr. 6 Geradeschneiden Langlochbohrer mit Spanbrecher. ( Art. 508 )

# 510

## Punta per mortasare a taglienti ambidestri

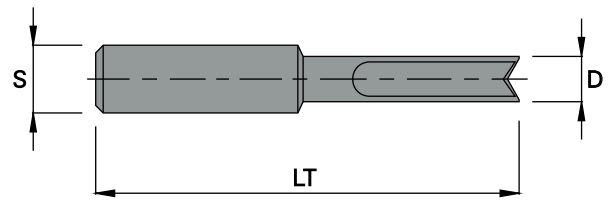

HL



D	LT	S	Z	COD.
6	100	16x50	2	0510060000
7	100	16x50	2	0510070000
8	100	16x50	2	0510080000
9	100	16x50	2	0510090000
10	110	16x50	2	0510100000
11	110	16x50	2	0510110000
12	110	16x50	2	0510120000
13	110	16x50	2	0510130000
14	110	16x50	2	0510140000
15	110	16x50	2	0510150000
16	110	16x50	2	0510160000



Reciprocating slot mortise bit.



Broca para taladro pendular.



Mèche à mortaiser à taillants ambidextres.



Pendelschlitzbohrer.

# 511

## Punta per mortasare a taglienti ambidestri

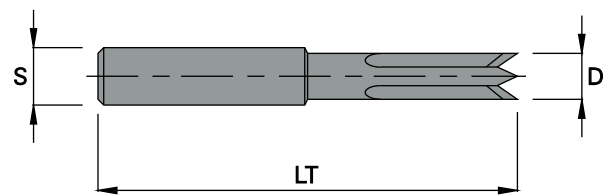

HL



D	LT	S	Z	COD.
6	73	10x40	4	0511060000
7	73	10x40	4	0511070000
8	73	10x40	4	0511080000
9	73	10x40	4	0511090000
10	73	10x40	4	0511100000
11	73	10x40	4	0511110000
12	73	10x40	4	0511120000
13	73	10x40	4	0511130000
14	73	10x40	4	0511140000
15	73	10x40	4	0511150000
16	73	10x40	4	0511160000



Reciprocating slot mortise bit.



Broca para taladro pendular.



Mèche à mortaiser à taillants ambidextres.



Pendelschlitzbohrer.

# 512

## Punta per mortasare a taglienti ambidestri

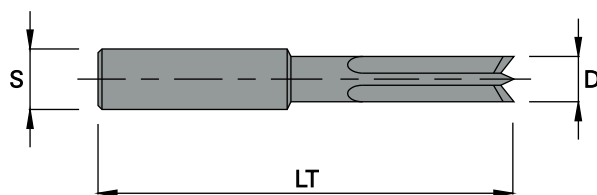

HL



D	LT	S	Z	COD.
6	100	13x50	4	0512060000
7	100	13x50	4	0512070000
8	100	13x50	4	0512080000
9	100	13x50	4	0512090000
10	110	13x50	4	0512100000
11	110	13x50	4	0512110000
12	110	13x50	4	0512120000
13	110	13x50	4	0512130000
14	110	13x50	4	0512140000
15	110	13x50	4	0512150000
16	110	13x50	4	0512160000

 Reciprocating slot mortise bit.

 Broca para taladro pendular.

 Mèche à mortaiser à taillants ambidextres.

 Pendelschlitzbohrer.

# 513

## Punta per mortasare a taglienti ambidestri

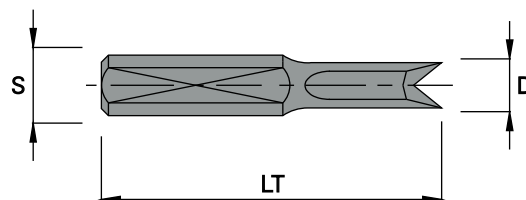

HL



D	LT	S	Z	COD.
6	60	12x30	2	0513060000
7	60	12x30	2	0513070000
8	60	12x30	2	0513080000
9	60	12x30	2	0513090000
10	60	12x30	4	0513100000
11	60	12x30	4	0513110000
12	60	12x30	4	0513120000

 Reciprocating slot mortise bit.

 Broca para taladro pendular.

 Mèche à mortaiser à taillants ambidextres.

 Pendelschlitzbohrer.

# 542

## Punta per esecuzione sede piastrina serrature

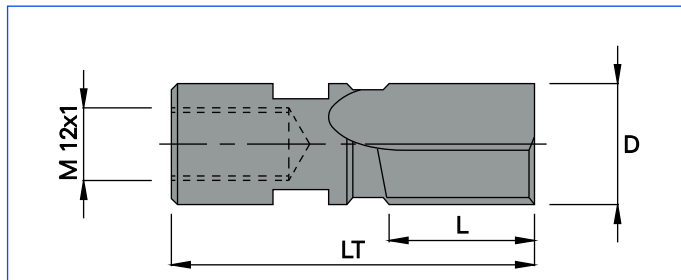

**HW**



D	L	LT	Z	MAT.	COD. RH
20	25	60	2	HW	05422000HW
22	25	60	2	HW	05422200HW



Drill for locks.



Broca para herrajes.



Mèche pour serrures.



Bohrer für Schloss.

# 544

## Punta per esecuzione asola serrature

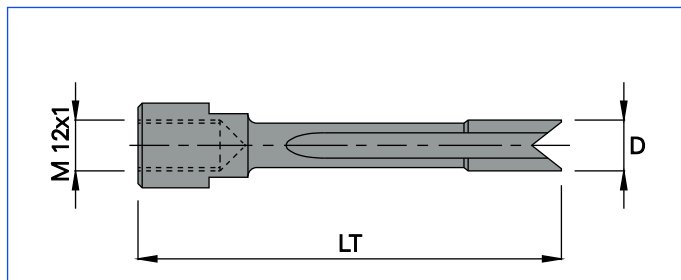
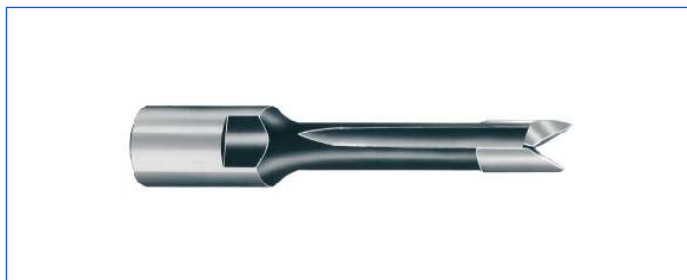

**HW**

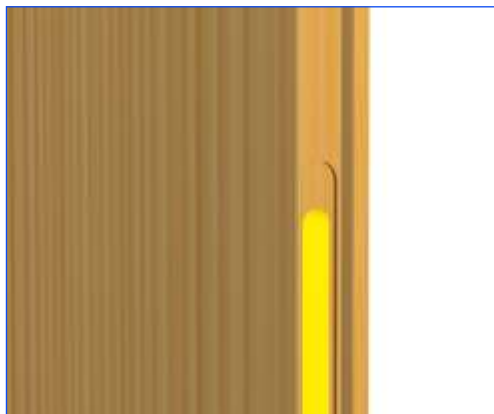

D	LT	Z	MAT.	COD. RH
12	100	2	HW	05441200HW
14	100	2	HW	05441400HW
16	100	2	HW	05441600HW
18	100	2	HW	05441800HW



Drill for locks.



Broca para herrajes.



Mèche pour serrures.



Bohrer für Schloss.

# 546

## Punta per esecuzione foro serrature

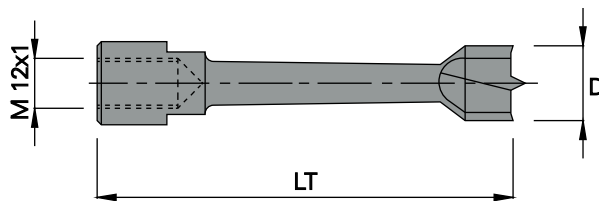

**HW**

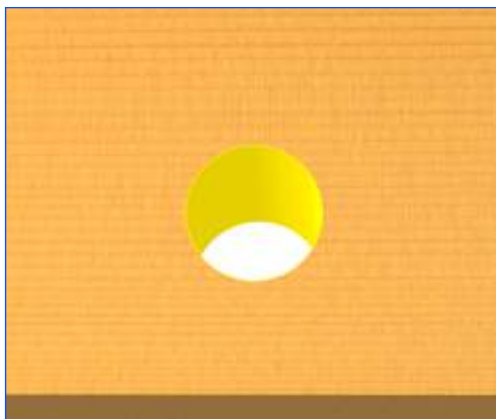

D	LT	Z	MAT.	COD. RH
18	100	2	HW	05461800HW
20	100	2	HW	05462000HW
22	100	2	HW	05462200HW

 Drill for locks.

 Mecha para herrajes.

 Mèche pour serrures.

 Bohrer für Schloß.

# 548

## Punta per esecuzione asola e foro serrature

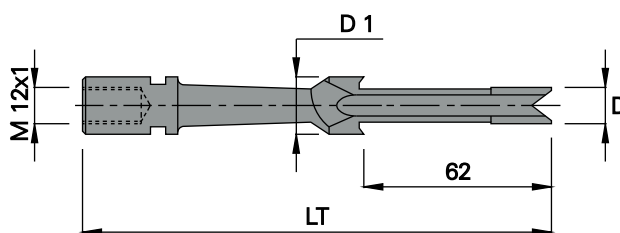

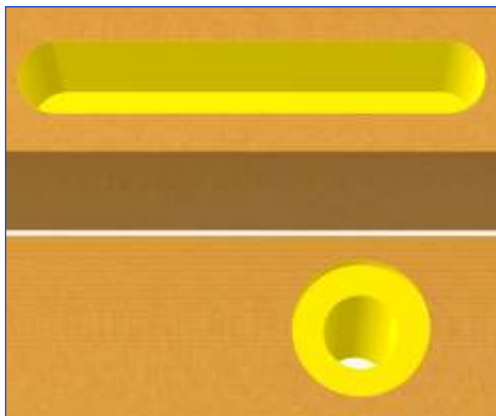

**HW**



D	D1	LT	Z	MAT.	COD. RH
10	18	155	2	HW	05481018HW
11	19	155	2	HW	05481119HW
12	19	155	2	HW	05481219HW

 Drill for locks.

 Mecha para herrajes.

 Mèche pour serrures.

 Bohrer für Schloß.